

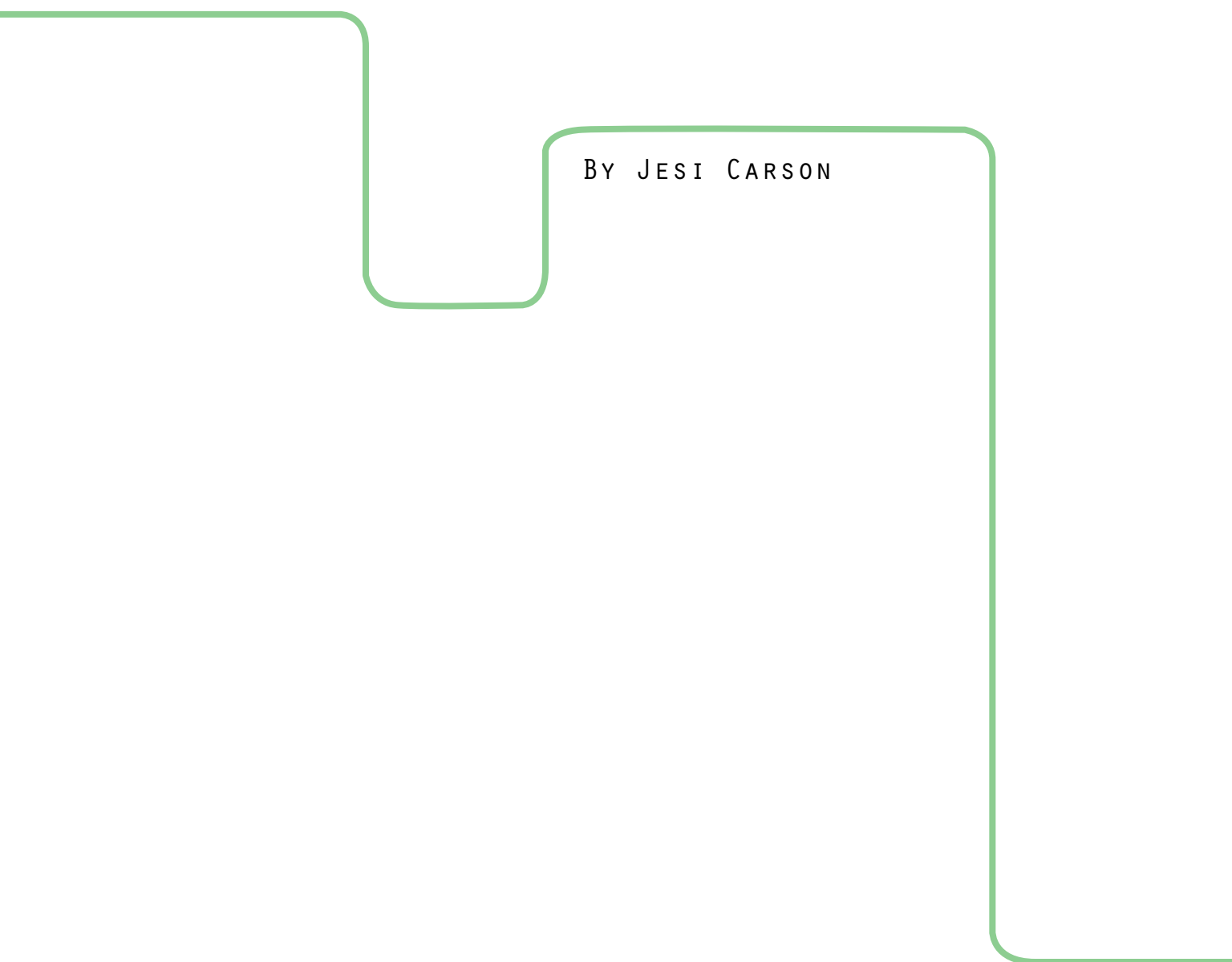

ART & DESIGN FOR THE FUTURE





BY JESI CARSON

2

L I V E



4

M A K E



S H O P

6

G O

8

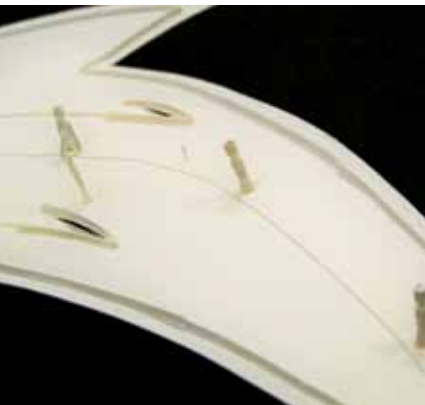

MY DREAM HOUSE



Why couldn't a home be made of a recycled shipping container? They just sit there, rusting, useless. This is a concept of a house, a home, a place of refuge and relaxation and personal reflection. My studiolo. My obsession. Sustainability plays a large role in this design. Research was eye opening. There are so, so very many resources available if you take the time to look for them.

This home is just an idea. But what if I could make it real? Or start with my own home? Small improvements can have a large impact. Plant a garden. Ride your bike. Tell your friends. You will be amazed.

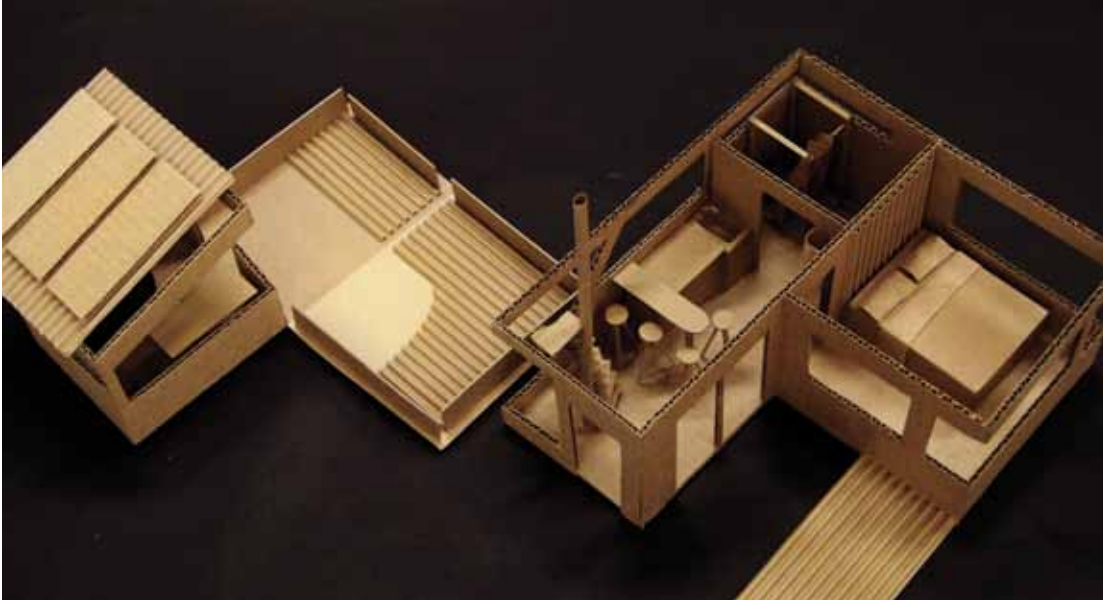

>Solar panels for personal water heating [enerworks.com]

>Low-flow faucets/ Dual-flush [americanstandard.com]

>Garden for seasonal food planting & ultimate local eating [ediblevancouver.com]

>Recycled countertops [cosentinonorthamerica.com]

>Bamboo flooring & decorative elements [plyboo.com]

>Felt area rugs [peaceindustry.com]

>Bike-friendly location

FEATURES

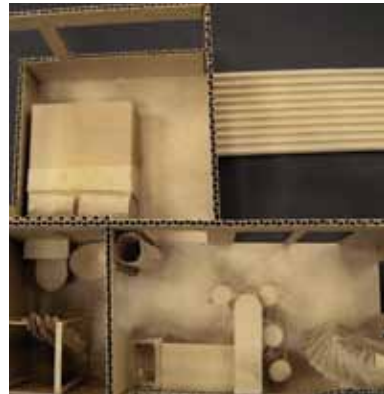

INDUSTRIAL DYSTOPIA

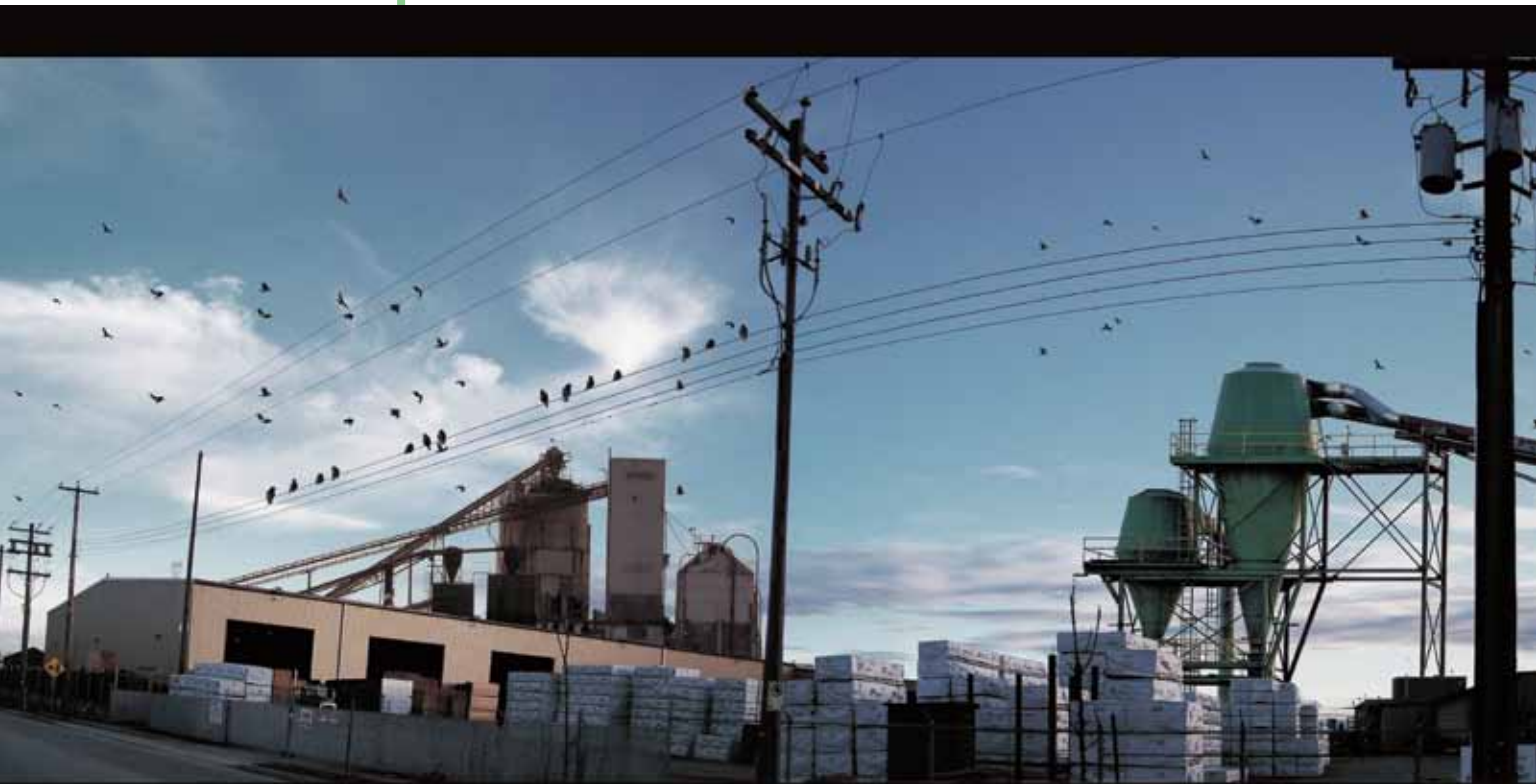



Where does your stuff come from? Is this dystopia really the story of our lives?

FOOD FOR THOUGHT

When you shop for beautiful and lovely things, do you consider where they were made? Who made them? What are they made of? Is the material sustainable? Is the material toxic to the environment? Is the production of the product harming the natural ecosystem? Is it helping to solve the ecological crisis one bowl at a time?

Check out this beautiful Eco Glass in stunning colours available at Cookworks in Vancouver. These gorgeous serving pieces are created entirely from recycled glass. Beautiful. [ecoglass.com] [cookworks.ca]





ARE YOU LIVING LOCAL?

Why is it so difficult to live local? Because there is a distinct lack of information available about where your STUFF comes from. Tracking a product's life cycle can be a difficult and tedious endeavor. But it is also critical to truly living local. Dig deeper people! Find the dirty details!

The "How local is your lunch?" urban intervention is designed to make viewers consider this aspect of their lives. Consider shopping at Farmer's Markets for fresh and local produce. Check out sites like ediblevancouver.com for a list of truly local vendors and creative ideas to pursue a local life, at least in the kitchen.

Go Go Go... GREEN



Bike and walk more. Simple. This conceptual pedestrian and bike bridge would connect David Lam Park and Charleston Park over the Burrard Inlet in Vancouver.

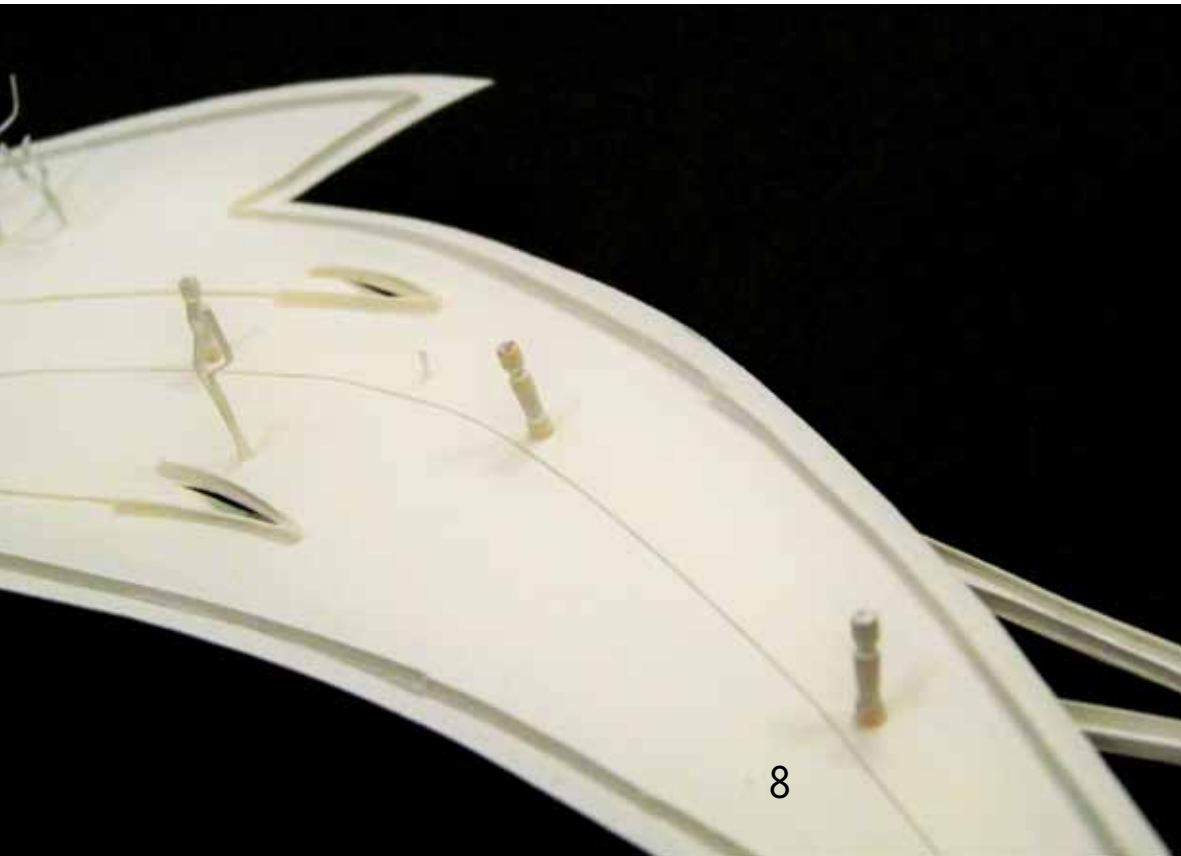

This line of cars goes on forever. Think of the waste. Think about riding your bike. It gets you from A to B, doesn't it?



